

BEASTS|2021

BEASTS showcases the dynamic practice of **Greg MOLLOY**. Combining all his skills this kinetic sculpture series is a study of hybridized anatomical structures of animal and human figure forms and industrial methods of construction present in musical instruments, stop-motion puppet armatures and furniture fabrication.

These beasts are constructed to command the space as industrial monsters with hypnotic oscillations of sound and mechanical movements that cause intrigue and unease.

Supported by Department of Local Government, Sport and Cultural Industries

To be opened by Associate Professor **Lyndall ADAMS**

Spectrum Project Space

Opening: 26 August 2021 5pm - 7pm

Speeches to take place at 6pm

Exhibition dates: 27 August - 16 September 2021

CREAtec floor talk: 15 September 2021 12:30pm - 1:30pm

Gallery opening hours: Tuesday to Friday 10am - 4pm

Building 3, 2 Bradford St, Mount Lawley

For all sale enquiries of works please contact the artist directly via
gregmolloyvisualartist@outlook.com



Department of
**Local Government, Sport
and Cultural Industries**

ECU Galleries



Biography

Greg Molloy is an Irish born artist (1994), who has been active in numerous exhibitions in WA since he graduated from Curtin University with a Bachelor of Arts in 2019.

Molloy has had had recent success with awards in the City of Bayswater and City of South Perth sculpture prizes, and acquiring a Department of Local Government, Sport and Culture grant to pursue an exhibition at Spectrum Project Space and other projects that will be active in more exhibitions during 2021. In early 2022 he will make his first appearance in Sculptures at Bathers.

Molloy is the Curator and Director of two recently established Artist Run Initiatives (ARI's) since January 2021. INTOO studios and ROOK ARI are spaces that support the future development of artists.

<https://intoostudios.org/>

Artist Statement

BEASTS delves into ideas and processes that develop into artworks where one could consider the work to be a Beast. Taming industrial materials. Repetitious processes that potentially lead to the infinite. Alluring encounters with tall quadrupedal grim figures. Time disorientating sound scapes. Hybridisation of anatomical and mechanical.

Throughout my studies and working life I combined all the skills I found in contemporary art practice from University, event management, furniture restoration and construction based environments of making. This constant adapting to new working environments has formed a dynamic practice that incorporates kinetic sculpture, interactive sound installations, print, drawing and performance.

My work interrogates the space with sound and form as large post industrial kinetic sculptures that hybridise methods in fabrication and production present in stop-motion animation, absurd theatre, industrial mid century furniture, musical instrument construction. I'm testing environments with my machines to create layered profound experiences for the viewer.

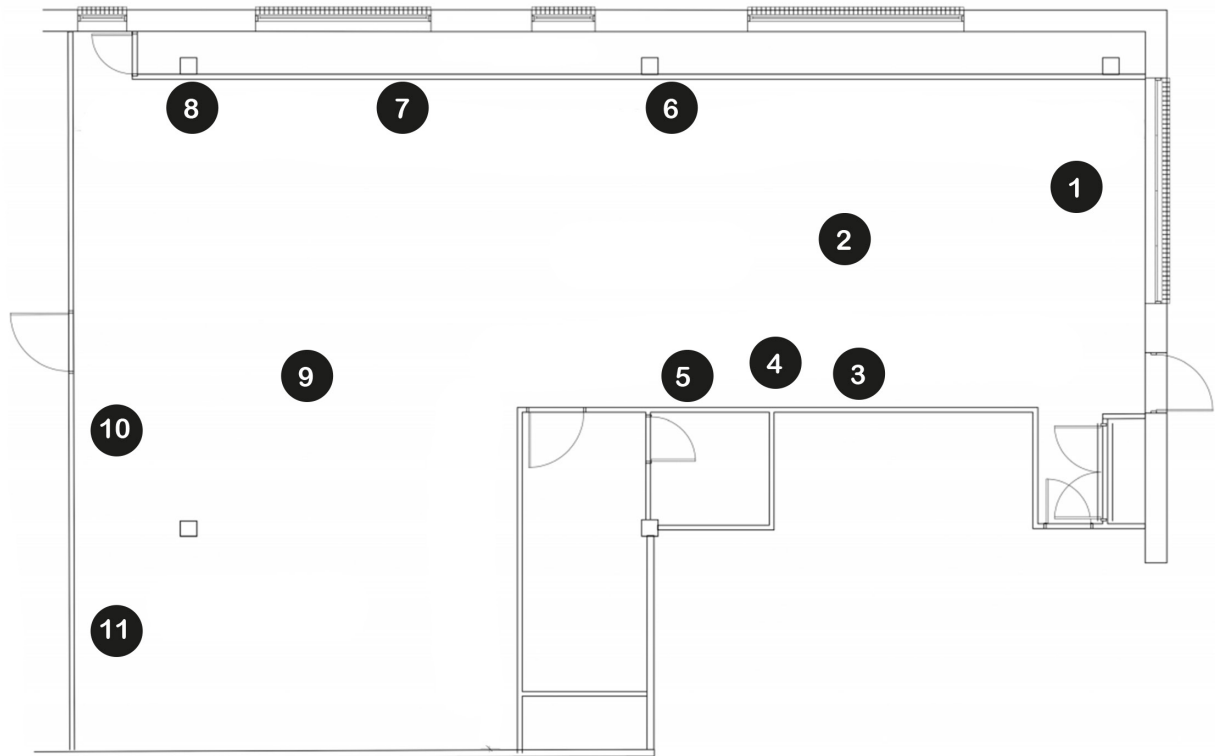

- 1** **Red Wheel**, 2021, 120 x 120 x 60cm, nylocs, washers, steel rod, stainless steel, electric motor, marbles, tamborines, triceratops toy, bells, chains. \$3000.
- 2** **Beast**, 2021, 200 x 200 x 200 cm, nylocs, washers, steel rod, stainless steel, electric motors, effect pedals, pick up, guitar string. \$10,000
- 3** **Spiralworks series 2**, 2021, 30 x 30 cm ea (600 x 150 cm total), monoprints. \$150 each
- 4** **Etching Machine**, 2019, 100 x 50 x 50 cm, nylocs, washers, stainless steel, steel rod, electric motors. NFS
- 5** **Spiralworks volume 1**, 2020, 32 x 33 x 8 cm, artist book. \$6000
- 6** **Dancing Beasts**, 2019, 120 x 120 x 120cm, nylocs, washers, stainless steel, steel rod, brass, chains, cymbals, electric motor. \$2000
- 7** **Spiralworks series 1**, 2019, 30 x 30 cm ea (600 x 150 cm total), monoprints. \$150 each

- 8 **Hopper**, 2020, 80 x 50 x 50 cm, nylocs, washers, stainless steel, steel rod, vibration motor, cymbals. \$2000
- 9 **ROOKERY**, 2021, 6 sculptures each approx. 100 x 100 x 100 cm, Stainless steel, nylocs, washers, steel rod, springs, electric motors, contact microphones, mixer, amplifier. \$3000
- 10 **BEAST Drawings**, 2019, 29.5 x 42 cm, Digital prints. \$70 ea (Edition of 3)
- 11 **Anatomy Studies**, 2019 - 2020, 26 x 36 cm ea, Digital prints. \$50 ea (Edition of 3)
- 12 **ROOK T-Shirts for Sale**, (Box Fit: Small, Medium or Large). \$40 ea

For all sale enquiries of works please contact the artist directly via
gregmolloyvisualartist@outlook.com