

# Half a Hundred | 2022

**Half a Hundred** by Professor **Glen PHILLIPS** is an exhibition of a selection of drawings and paintings of landscapes across Australia, Italy and China.

Book launch of “100 Landscapes” and Exhibition opening by  
Professor **Clive BARSTOW**

Please register all sales enquiries to the Front of House staff in the Gallery  
or contact Glen Phillips via [glenlyp@bigpond.com](mailto:glenlyp@bigpond.com)

**Gallery25**

Opening Event: 19 Jan 2022 12.30pm - 1.30pm  
Exhibition dates: 11 - 21 Jan 2022  
Gallery opening hours: Tuesday to Friday 10am - 4pm  
Building 10, 2 Bradford St, Mount Lawley

**ECU Galleries**



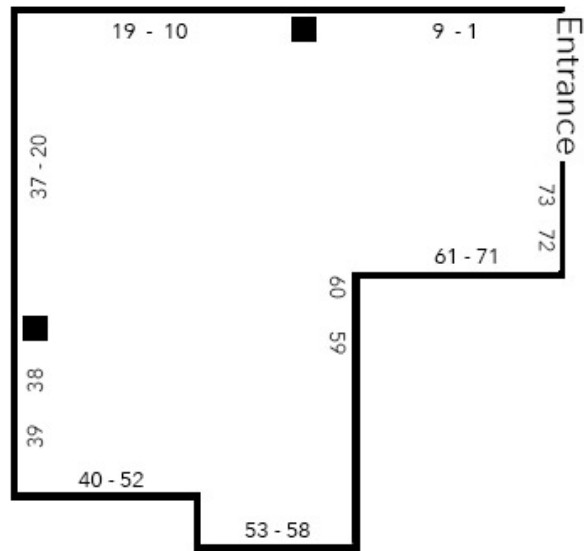

- 1 **Busselton Jetty**, 2010, watercolour, 22.5 x 15cm (framed). NFS.
- 2 **The Lakes, Lake Grace**, 2021, pen/wash, 28.5 x 18.5cm, \$50
- 3 **North Lake Grace**, 2021, pen/wash, 28.5 x 18.5cm, \$50
- 4 **Pingelly-Wandering Road**, 2021, pen/wash, 23 x 16cm, \$50
- 5 **Near Yallingup**, 2021, pen/wash, 22.5 x 19cm, \$50
- 6 **Bennett's Crossing, Lake Grace**, 2021, pen/wash, 29 x 22cm, \$50
- 7 **Lake Ballard**, 1995, pen/wash, 26 x 18.5cm, \$50
- 8 **The Lakes, Bally Bally**, 2019, watercolour, 25 x 25cm, \$50
- 9 **Bremer Bay**, 1973, watercolour, 36.5 x 26 cm (framed). NFS
- 10 **Stirling Ranges**, 2018, watercolour, 23 x 18cm (framed). NFS
- 11 **Jarrah Forrest**, 1970, watercolour, 33.5 x 26cm (framed). NFS
- 12 **Leaning Tree**, 2008, pen/wash, 29 x 21cm, \$50
- 13 **Gravel Pit, Pingelly**, 2008, pen/wash, 29 x 21cm, \$50
- 14 **Pinnacles Desert National Park**, 2011, pen/wash, 28 x 20cm, \$50
- 15 **Dale River Road**, 2000, pen/wash, 17.5 x 13cm, \$25
- 16 **Redgum Forest**, 2004, pen/wash, 29 x 21cm, \$50
- 17 **Country Peak: Yenyening Lakes**, 2019, pen/wash, 20 x 14.5cm, \$25
- 18 **Granite and Sheoaks, Hyden**, 2015, pen/wash, 19.5 x 29.5cm, \$50
- 19 **Two Trees**, 1962, watercolour, 130 x 85cm (framed). NFS.

- 20 **Woodlands Desert National Park**, 1962, pen/wash, 36.5 x 26cm (framed). NFS
- 21 **Goldfields Pipeline near Cunderdin**, 2017, pen/wash, 28 x 18cm, 50
- 22 **Jam Tree Corner**, 2017, pen/wash, 28 x 17cm 50
- 23 **Powder Bark Gums, County Peak** 2005, watercolour, 16.5 x 22.5cm 50
- 24 **Old School**, 2005, pen/wash, 29 x 21cm 50
- 25 **Rust in Peace**, 2017, watercolour, 18 x 14cm, \$25
- 26 **Salt Lake Sunset, Lake Grace**, 2021, watercolour, 18.5 x 22.5cm \$50
- 27 **Stony Farm Corner**, 2010, pen/wash, 18 x 13cm \$25
- 28 **Kulyalling Inn Ruins**, 2016, pen/wash, 21.8 x 13.5cm \$25
- 29 **Hall Corner, Bally Bally**, 2021, pen/wash, 29 x 11cm, \$50
- 30 **Brookton Road**, 2021, pen/wash, 18 x 13cm, \$25
- 31 **Pingelly, WA**, 2021, pen/wash, 21 x 13cm \$25
- 32 **Pingelly - Wandering Road**, 2021, pen/wash, 23 x 16cm \$25
- 33 **Sheds and Stables, Woodlands**, 2008, watercolour, 17.5 x 20cm \$25
- 34 **Country Road near Bruce Rock**, 2018, pen/wash, 29 x 21cm \$50
- 35 **In the Hollow of the Land**, 2012, pen/wash, 29 x 21cm \$50
- 36 **Armadale Brickworks**, 2021, pen/wash, 18 x 13cm, \$25
- 37 **Late School Bus**, 2010, pen/wash, 25.5 x 19.5cm \$50
- 38 **The Mined Mind**, 1992, offset text, 51 x 35cm (framed). NFS
- 39 **Omens**, 1992, offset text, 51 x 35cm (framed). NFS
- 40 **Emu Chick**, 2021, pen and ink, 12.8 x 17.5mm, \$25
- 41 **Granite Kunzea Tree**, 1995, pen/wash, 27 x 19.5cm, \$25
- 42 **Gimlet**, 2017, pen/wash, 18 x 12.5mm, \$25
- 43 **Banksia Menziesii**, 2015, pen/wash, 18 x 13cm, \$25
- 44 **Kondinin Blackbutts**, 2021, pen/wash, 15 x 20cm, \$25
- 45 **Balgas**, 2021, watercolour, 21 x 11cm, \$25
- 46 **Sugar Gum, Pingelly**, 2021, pen/wash, 21 x 16cm, \$25
- 47 **Coastal Peppermints**, 2019, pen/wash, 18 x 12cm, \$25

- 48 **Echidna**, 2014, pen/wash, 15 x 10cm, \$25
- 49 **Quandong Fruit**, 2017, watercolour, 11 x 13cm, \$25
- 50 **Gimlet, Eucalyptus salubris**, 2007, pen/wash, 12.5 x 18cm, \$50
- 51 **Nuytsial Floribunda, Moojar**, 2017, pen/wash and text, 27.5 x 19cm (framed). NFS.
- 52 **Salmon Gums and Wodjil**, 2019, pen/wash, 11 x 16cm, \$25
- 53 **Canal and Arch, China**, 2021, pen/wash, 23.5 x 20cm, \$50
- 54 **Jiangsu Teahouse, China**, 2018, pen/wash, 29 x 21cm, \$50
- 55 **Burning Rice Stubble, China**, 2009, pen/wash, 25 x 18cm, \$50
- 56 **Jinjiang Village, China**, 2008, watercolour, 10.5 x 14.5cm, \$25
- 57 **Shaanxi Village, China**, 2021, watercolour, 17.5 x 12cm, \$25
- 58 **Great Wall near Chengde, China**, 2010, pen/wash, 27.5 x 20cm, \$50
- 59 **Old Postalesio, Italy**, 1985, watercolour, 25 x 16.5cm (framed). NFS
- 60 **Canal, Venice, Italy**, 2018, watercolour, 51 x 44cm (framed). NFS
- 61 **SE View of Postalesio, Italy**, 1980, p&l 29 x 21cm (framed). NFS
- 62 **Temples at Agrigento, Italy**, 2021, p&l, 21 x 26cm (framed). NFS
- 63 **Postalesio Village, Italy**, 2018, watercolour, 29 x 21cm, \$50
- 64 **Old Postalesio Village, Italy**, 2018, watercolour, 29 x 21cm, \$50
- 65 **Toscana farm scene**, 1991, pen/wash, 18 x 13cm, \$25
- 66 **Apennine skyline, Italy**, 1991, pen/wash, 18 x 13cm, \$25
- 67 **Sinagra, siciliy** 2020, 51 x 44cm (framed). NFS
- 68 **Passo del Foscagno, Italy**, 2021, watercolour, 17.5 x 13cm, \$25
- 69 **Chiuro Station, Italy**, 2021, pen/wash, 28 x 24cm, \$50
- 70 **Etruscan Arch, Italy**, 2017, pen/wash, 29 x 21cm, \$50
- 71 **Old Postalesio, Italy**, 1980, p&l, 29 x 21cm (framed). NFS
- 72 **Tuscany, Italy**, 2019, watercolour, 51 x 44cm (framed). NFS
- 73 **Tuscany farm scene**, 2020, p/w (framed), 51 x 44cm (framed). NFS